

The top view of the circuit board is square with a central circular feature consisting of two concentric circles. The board is divided into four quadrants by a horizontal and a vertical centerline. In each corner, there is a circular component with a cross inside, and a smaller circular component is located just inside the corner. Along each side, there is a circular component with a cross inside, and a smaller circular component is located just inside the side. The board is mounted on a rectangular base.

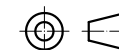
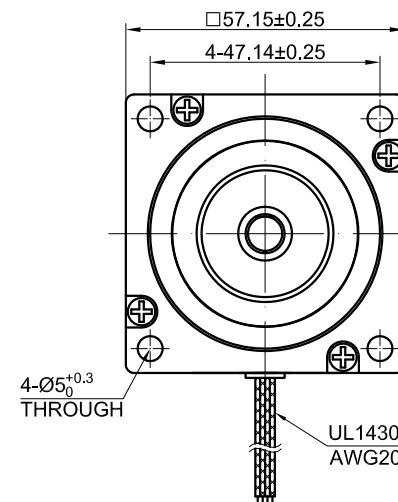
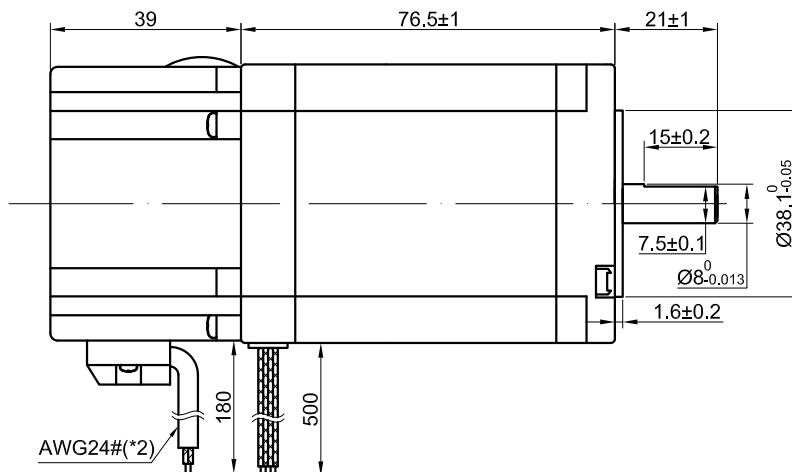

SPECIFICATION	CONNECTION	BIPOLAR			
AMPS/PHASE		5.00			
RESISTANCE/PHASE(Ohms)@20°C		0.40±10%			
INDUCTANCE/PHASE(mH)@1KHz		1.80±20%			
HOLDING TORQUE(Nm)[lb-in]		2.00 [17.71]			
STEP ANGLE(°)		1.8±0.09			
MAXIMUM RADIAL RUNOUT(mm)@LOAD 450g		0.025			
MAXIMUM AXIAL RUNOUT(mm)@LOAD 920g		0.075			
ROTOR INERTIA(g-cm²)		480			
WEIGHT(Kg)[lb]		—			
TEMPERATURE RISE:MAX.80°C (MOTOR STANDSTILL;FOR 2PHASE ENERGIZED)					
OPERATION AMBIENT TEMPERATURE 0°C~50°C[ 32°F~122°F]					
INSULATION RESISTANCE 100 Mohm (UNDER NORMAL TEMPERATURE AND HUMIDITY)					
INSULATION CLASS B 130°C[266°F]					
DIELECTRIC STRENGTH 500VAC FOR 1MIN.(BETWEEN THE MOTOR COILS AND THE MOTOR CASE)					
		APVD		7.12.2019	STEPPER MOTOR
		CHKD			
	1:1.5	DRN			23BK20-20
	SCALE	SIGNATURE	DATE		

TYPE OF CONNECTION  
(EXTERN)

PIN NO

BIPOLAR

1A —

2A\ —

3B —

4B\ —

LEADS

BLK

GRN

RED

BLU

WINDING

BRAKE CONNECTIONS

24V 2.0N.m

MOTOR CONNECTIONS

FULL STEP 2 PHASE-Ex. ,  
WHEN FACING MOUNTING END (X)

STEP	A	B	A\	B\	CCW	
1	+	+	-	-	↓	
2	-	+	+	-	↑	
3	-	-	+	+		
4	+	-	-	+		