

C VIEW

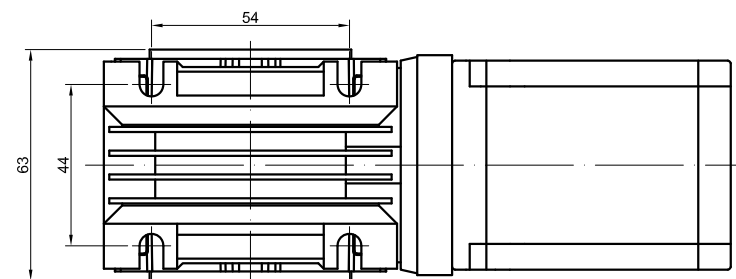

| SPECIFICATION | CONNECTION | BIPOLAR |
|--|------------|---------------|
| AMPS/PHASE | | 2.80 |
| RESISTANCE/PHASE(Ohms)@25°C | | 1.13±10% |
| INDUCTANCE/PHASE(mH)@1KHz | | 4.80±20% |
| HOLDING TORQUE w/o GEARBOX(Nm)[lb-in] | | 1.90[16.82] |
| STEP ANGLE w/o GEARBOX(°) | | 1.80±5.00% |
| GEAR RATIO | | 30 |
| MAX.PERMISSIBLE TORQUE(Nm)[lb-in] | | 20.00[177.01] |
| EFFICIENCY | | 65% |
| SHAFT MAXIMUM RADIAL LOAD(kN) | | 1.08 |
| BACKLASH@NO-LOAD(°) | | 1 |
| TEMPERATURE RISE:MAX.80°C (MOTOR STANDSTILL;FOR 2PHASE ENERGIZED) | | |
| AMBIENT TEMPERATURE -10°C~50°C[14°F~122°F] | | |
| INSULATION RESISTANCE 100 Mohm (UNDER NORMAL TEMPERATURE AND HUMIDITY) | | |
| INSULATION CLASS B 130°C[266°F] | | |
| DIELECTRIC STRENGTH 500VAC FOR 1MIN.(BETWEEN THE MOTOR COILS AND THE MOTOR CASE) | | |

| TYPE OF CONNECTION (EXTERN) | | MOTOR | |
|-----------------------------|---------|-------|---------|
| PIN NO | BIPOLAR | LEADS | WINDING |
| 1 | A+ — | BLK | A+ |
| 2 | A- — | GRN | A- |
| 3 | B+ — | RED | B+ |
| 4 | B- — | BLU | B- |

FULL STEP 2 PHASE-Ex. ,
WHEN FACING MOUNTING END (X)

| STEP | A+ | B+ | A- | B- | | CCW |
|------|----|----|----|----|---|-----|
| 1 | + | + | - | - | ↓ | ↑ |
| 2 | - | + | + | - | | |
| 3 | - | - | + | + | ↑ | ↓ |
| 4 | + | - | - | + | | |

| | | |
|-------|-----------|-----------|
| APVD | | 11.7.2022 |
| CHKD | | |
| 1:1.5 | DRN | |
| SCALE | SIGNATURE | DATE |

STEPPER MOTOR

23HS30-2804S-RV30-G30